

Sight glass fitting TYPE BS04



description:

Sight flow indicators are used for observation and to illuminate optical control of fluids and gases. E.g. tanks, silos, boilers...

features:

- suitable for neutral and non-neutral **liquids and gaseous media.**
- with borosilicate glass DIN 7080
- Delivery includes: Base- & cover flange, glass & sealing
- High quality stainless steel

Connection:

DN50, DN80, DN100, DN125, DN150, DN200

Design:

acc. DIN 28120

Pressure:

0,0 Bar

Design:

Material base-flange:

to be welded directly to tank

Material cover-flange:

stainless steel 1.4571

Seal:

stainless steel 1.4571

Glass:

C4400

Screws:

borosilicate glass DIN 7080

Temperature:

A4-70

Delivery includes:

0°C to +150°C

Base- & cover flange, glass & sealing

Dimensions:

DN	Di	Da	Gewicht
50	80	140	2,5
80	100	165	3,0
100	125	190	3,6
125	150	215	4,5
150	175	240	5,4
200	225	290	8,9

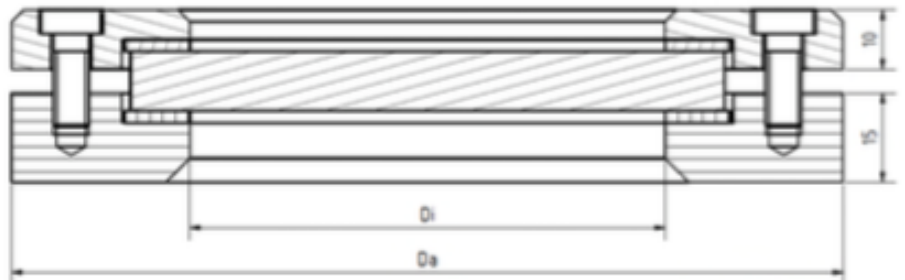

Article number:

Type	Glass	Version	Size
BS04	00 – borosilicate glass	00 – Standard	08 – DN50 10 – DN80 11 – DN100 12 – DN125 13 – DN150 14 – DN200

Example no. BS04000010:

BS04	00	00	10
-------------	-----------	-----------	-----------

Article no. BS04000010

Sight glass fitting

Glass: borosilicate glass

Size: DN80

Image similar, subject change without notice.