

Sight glass fitting DIN 28120 TYPE BS02



description:

Sight flow indicators are used for observation and to illuminate optical control of fluids and gases. E.g. tanks, silos, boilers...

features:

- suitable for neutral and non-neutral **liquids and gaseous media.**
- with borosilicate glass DIN 7080
- Delivery includes: Base- & cover flange, glass & sealing

Connection:

DN25, DN50, DN80, DN100, DN125, DN150, DN200

Design:

DIN 28120

Pressure:

max. 16 bar

Design:

to be welded directly to tank

Material base-flange:

stainless steel 1.4571

Material cover-flange:

stainless steel 1.4571

Seal:

C4400

Glass:

borosilicate glass DIN 7080

Screws:

A4-70

Temperature:

0°C to +150°C

Delivery includes:

Base- & cover flange, glass & sealing

Dimensions:

DN	PN	d1	d3	s	D	k	h	h2
25	10/16	48	63	10	115	85	16	25
50	10/16	80	100	15	165	125	16	30
80	10/16	100	125	15/20	200	160	20	30
100	10/16	125	150	20/25	220	180	22	30
125	10/16	150	175	20/25	250	210	25	30
150	10/16	175	200	25/30	285	240	30	36
200	10	225	250	30	340	295	35	36

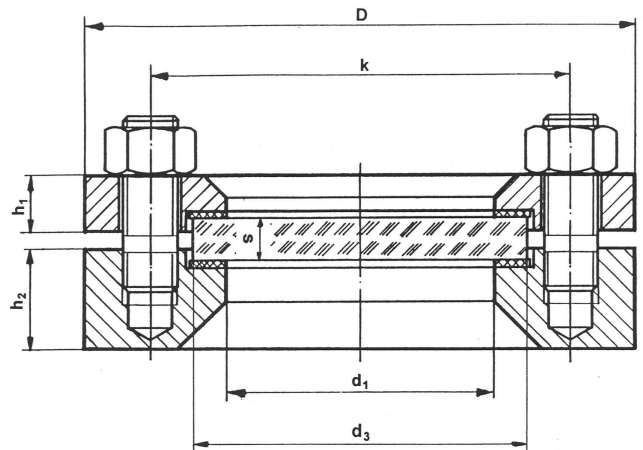

Article number:

Type	Glass	Version	Size
BS02	00 – borosilicate glass	00 – Standard	05 – DN25 08 – DN50 10 – DN80 11 – DN100 12 – DN125 13 – DN150 14 – DN200

Example no. BS02000010:

BS02	00	00	10
-------------	-----------	-----------	-----------

Article no. BS02000010

Sight glass fitting

Glass: borosilicate glass

Size: DN80

Image similar, subject change without notice.