

Stainless steel pressure reducing valve type DM12 | DM19

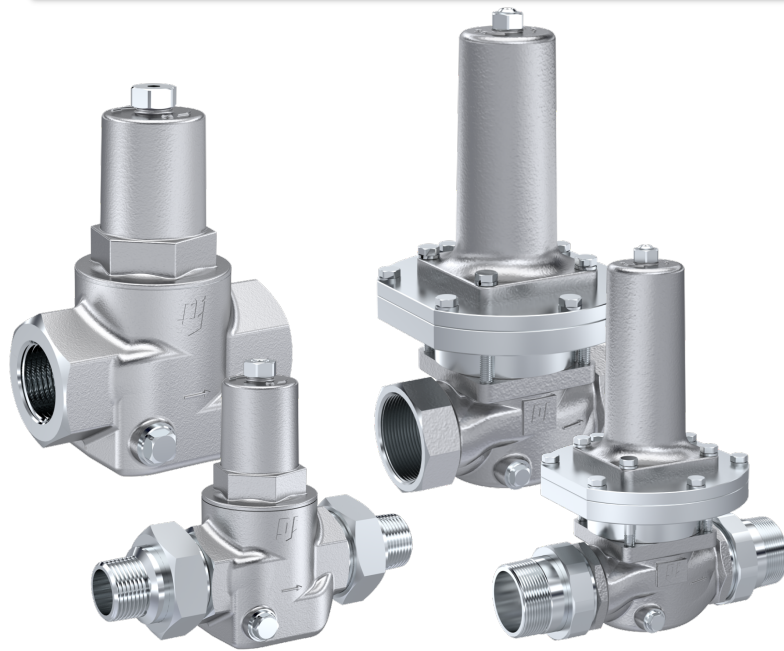

Description:

Stainless steel pressure reducing valves are used to regulate the supply pressure in a system, to compensate for different inlet pressures to a certain pressure in the outlet side.

Features:

- suitable for aggressive water and other aggressive fluids
- **suitable for air & neutral non-inflammable gases**
- industrial design – full metal
- Built-in dirt trap and 1 manometer connection G 1/4" inch axial
- mounting position: any

Connection:

1/2", 3/4", 1", 1 1/4", 1 1/2", 2"

Temperature:

-30°C to +190°C
Depending on design

Pressure:

Inlet pressure: up to 40,0 bar
Outlet pressure: 0,2 bar - 9,0 bar
Depending on design

Subject to PED 2014/68/EU category I

Design:

Diaphragm-pressure reducing valve with built-in dirt trap

Body:

Stainless steel 1.4408

Spring bonnet:

Stainless steel 1.4408

diaphragm:

TYP DM12 FKM / FPM -10°C to +190°C

TYP DM19 EPDM (FDA konform) -30°C to +130°C

Internals:

Stainless steel 1.4404

Assembly position:

any, preferably vertical

Connection:

Female thread acc. to ISO 228 or NPT

Male thread acc. To ISO 7 / BSP-T

Outlet pressure:

	Outlet pressure	Inlet pressure
Spring 00	1,5 to 6,0 bar	Up to 40,0 bar
Spring 01	0,2 to 2,0 bar	Up to 25,0 bar
Spring 02	0,5 to 9,0 bar	Up to 40,0 bar

Minimum pressure difference:

Inlet-/outlet pressure 1 bar

Note:

Type DM19 with EPDM seal comes with **FDA-conformity**, therefore it can be used for food-applications.

Dimensions:

Female thread:

Diameter DN	15	20	25	32	40	50
Female thread G	1/2"	3/4"	1"	1 1/4"	1 1/2"	2"
h1	29	29	38	38	38	38
h2	116	116	116	116	219	219
L	95	95	110	120	150	160
Kvs-value m3/h	2,9	3,9	5,4	6,1	9	13
Weight kg	1,4	1,3	2,1	2,0	5,4	5,3

Low pressure design 0,2 - 2,0 bar

h1	29	29	38	38	38	38
h2	136	136	148	148	271	271
L	95	95	110	120	150	160
Kvs-value m3/h	2,9	3,9	5,4	6,1	9	13
Strainer mesh size	0,32	0,32	0,32	0,32	0,6	0,6
weight kg	1,8	1,7	3,1	3,1	9,1	9,0

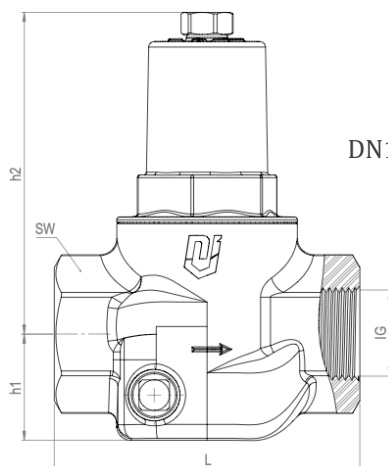

DN15-DN25

Standard

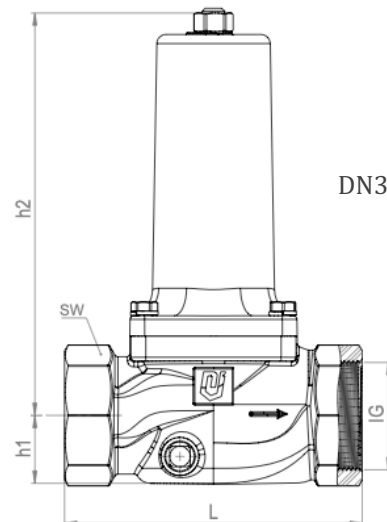

DN32-DN50

Low pressure

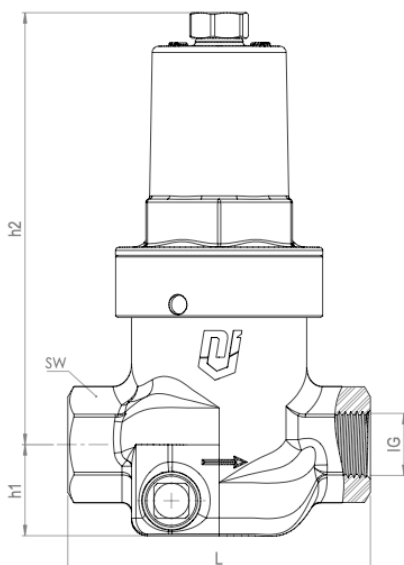

DN15-DN20

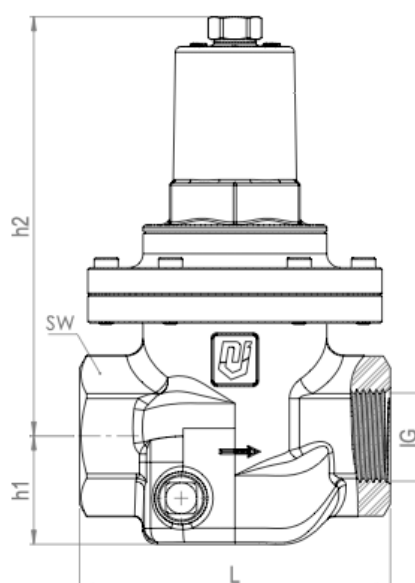

DN25-DN32

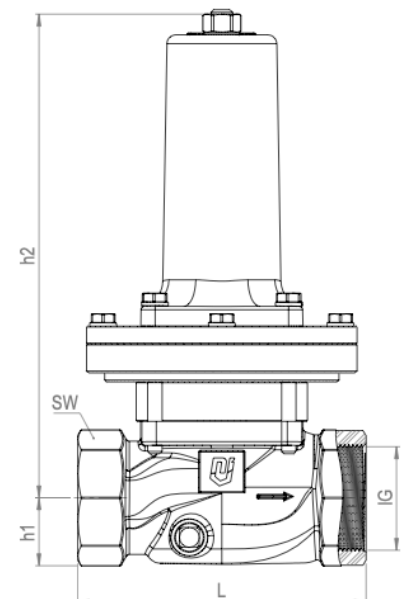

DN40-DN50

Male thread:

Diameter DN	15	20	25	32	40	50
Female thread G	1/2"	3/4"	1"	1 1/4"	1 1/2"	2"
h1	29	29	38	38	39	39
h2	116	116	116	116	219	219
L1	105	105	122	122	160	160
L2	168	168	195	195	250	250
Kvs-value m3/h	2,9	3,9	5,4	6,1	9	13
Weight kg	1,6	1,6	2,8	2,9	6,6	6,6

Low pressure design 0,2 - 2,0 bar

h1	29	29	38	38	39	39
h2	136	136	148	148	271	271
L1	105	105	122	122	160	160
L2	168	168	195	195	250	250
Kvs-value m3/h	2,9	3,9	5,4	6,1	9	13
Strainer mesh size	0,32	0,32	0,32	0,32	0,6	0,6
weight kg	2,0	2,0	3,8	3,9	10,3	10,2

Standard

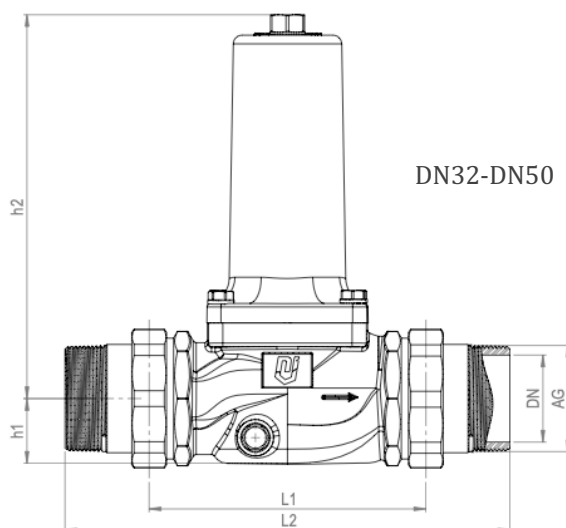
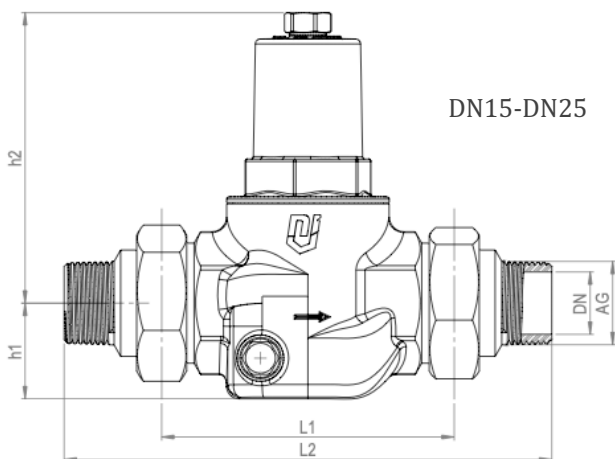

Low pressure

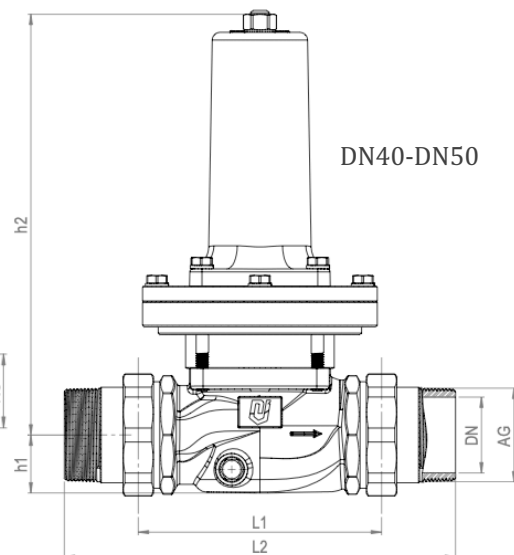
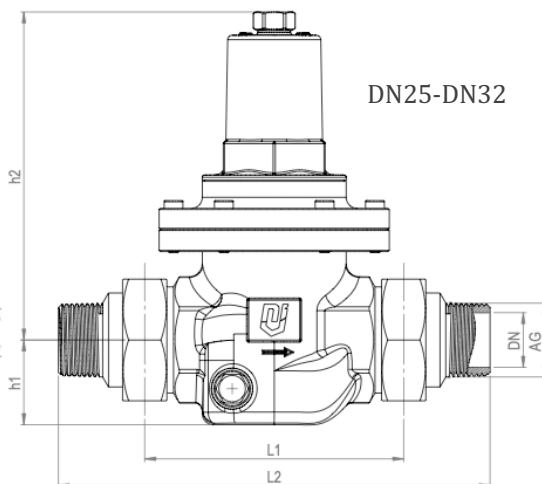
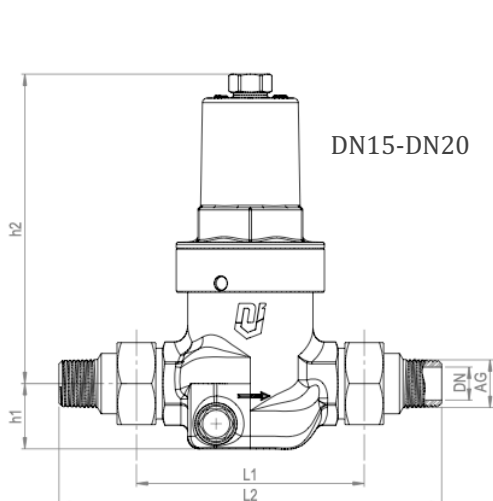

pressure-temperature-diagram:

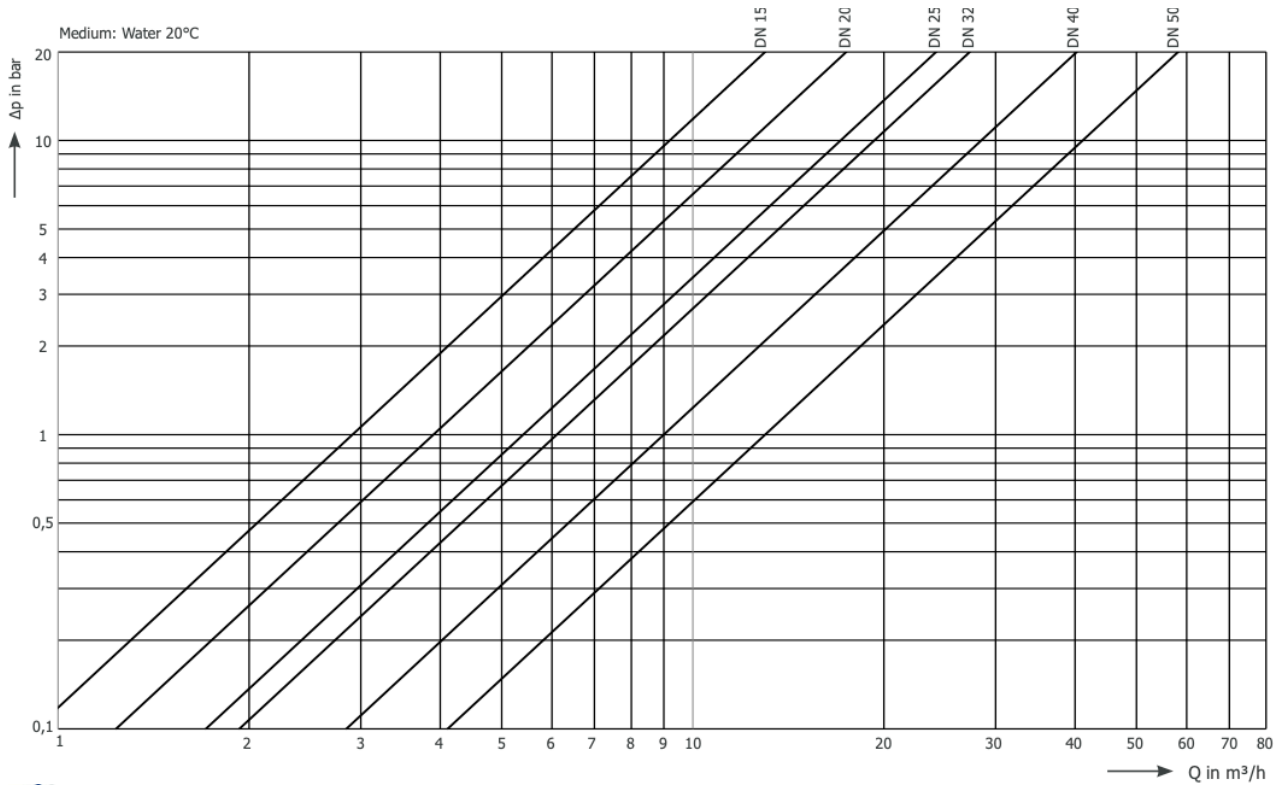

Article number:

Type	Outlet pressure	Connection	Size
DM12 – FPM	00 – 1,5 up to 6,0 bar	00 – female thread BSP	03 – 1/2"
DM19 – EPDM	01 – 0,2 up to 2,0 bar	01 – female thread NPT	04 – 3/4"
	02 – 0,5 up to 9,0 bar		05 – 1"
			06 – 1 1/4"
			07 – 1 1/2"
			08 – 2"

Example No. DM12000103:

DM12 | 00 | 01 | 03

Pressure reducing valve made of stainless steel
 Outlet pressure: 1,5 up to 6,0 bar
 Diaphragm: FPM
 Connection: female thread NPT
 Size: 1/2"

Image similar, subject change without notice.