

# NPT-Fittings stainless steel TYPE GF04

## angle 90° \*

**Name:** angle 90°  
**Type:** GF04-0  
**Material:** Stainless steel 316  
**Connection:** female thread  
**Thread:** NPT acc. to ANSI B1.20.1

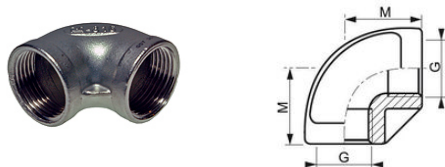

Size G	M in mm	Weight in kg	Article no.
1/4"	20	0,038	GF04000101
3/8"	24	0,054	GF04000102
1/2"	28	0,062	GF04000103
3/4"	32	0,086	GF04000104
1"	38	0,148	GF04000105
1 1/4"	45	0,240	GF04000106
1 1/2"	50	0,300	GF04000107
2"	58	0,465	GF04000108
2 1/2"	70	0,880	GF04000109
3"	78	1,300	GF04000110

**Name:** angle 90°  
**Type:** GF01-0  
**Material:** Stainless steel 316  
**Connection:** female x male thread  
**Thread:** NPT acc. to ANSI B1.20.1



Size G	M in mm	N in mm	Weight in kg	Article no.
1/4"	20	28	0,036	GF04001101
3/8"	24	36	0,047	GF04001102
1/2"	28	40	0,065	GF04001103
3/4"	32	46	0,100	GF04001104
1"	38	54	0,160	GF04001105
1 1/4"	45	62	0,270	GF04001106
1 1/2"	50	69	0,330	GF04001107
2"	58	80	0,534	GF04001108
2 1/2"	70	98	1,100	GF04001109
3"	78	112	1,360	GF04001110

## cross-fitting \*

**Name:** cross-fitting  
**Typ:** GF04-1  
**Material:** Stainless steel 316  
**Connection:** female thread  
**Thread:** NPT acc. to ANSI B1.20.1

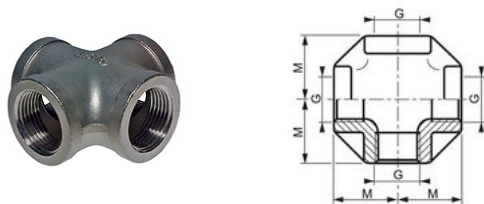

Size G	M in mm	Weight in kg	Article no.
1/8"	17	0,041	GF04101100
1/4"	20	0,061	GF04101101
3/8"	24	0,090	GF04101102
1/2"	28	0,105	GF04101103
3/4"	32	0,140	GF04101104
1"	38	0,230	GF04101105
1 1/4"	45	0,376	GF04101106
1 1/2"	50	0,468	GF04101107
2"	58	0,760	GF04101108

## T-fitting \*

**Name:** T-fitting  
**Typ:** GF04-1  
**Material:** Stainless steel 316  
**Connection:** female thread  
**Thread:** NPT acc. to ANSI B1.20.1

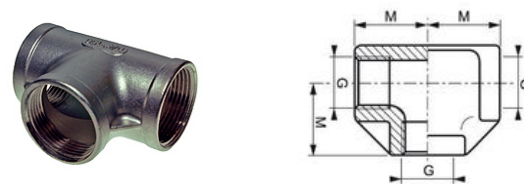

Size G	M in mm	Weight in kg	Article no.
1/8"	17	0,033	GF04100100
1/4"	20	0,050	GF04100101
3/8"	24	0,069	GF04100102
1/2"	28	0,085	GF04100103
3/4"	32	0,121	GF04100104
1"	38	0,185	GF04100105
1 1/4"	45	0,310	GF04100106
1 1/2"	50	0,385	GF04100107
2"	58	0,630	GF04100108

**reducing nipple \***

**Name:** reducing nipple  
**Typ:** GF04-2  
**Material:** Stainless steel F316L  
**Connection:** male thread  
**Thread:** NPT acc. to ANSI B1.20.1

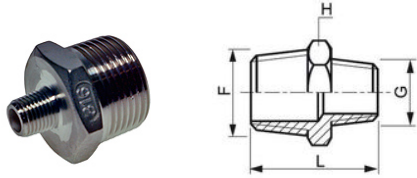

Size FxG	L in mm	H in mm	Weight in kg	Article no.
1/4" x 1/8"	27	14	0,010	GF04200000
3/8" x 1/8"	29	19	0,025	GF04200001
3/8" x 1/4"	30	19	0,025	GF04200002
1/2" x 1/4"	32	23	0,040	GF04200004
1/2" x 3/8"	33	23	0,040	GF04200005
3/4" x 3/8"	38	27	0,070	GF04200007
3/4" x 1/2"	39	27	0,070	GF04200008
1" x 1/2"	43	36	0,130	GF04200010
1" x 3/4"	47	36	0,130	GF04200011
1 1/4" x 1"	52	46	0,280	GF04200014
2" x 1 1/2"	57	60	0,500	GF04200020

**double nipple \***

**Name:** double nipple (6-kt.)  
**Typ:** GF04-3  
**Material:** Stainless steel 316  
**Connection:** male thread  
**Thread:** NPT acc. to ANSI B1.20.1

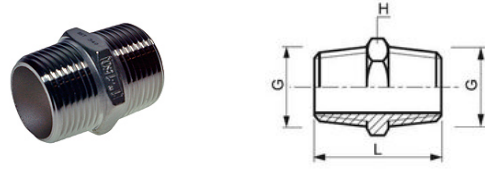

Size G	L in mm	H in mm	Weight in kg	Article no.
1/8"	25	12	0,007	GF04300000
1/4"	33	15	0,016	GF04300001
1/2"	42	23	0,041	GF04300003
3/4"	48	29	0,062	GF04300004
1"	52	36	0,099	GF04300005
1 1/4"	58	46	0,156	GF04300006
1 1/2"	58	52	0,203	GF04300007
2"	64	63	0,350	GF04300008

**lid \***

**Name:** lid (6-kt.)  
**Typ:** GF04-3  
**Material:** Stainless steel 316L  
**Connection:** female thread  
**Thread:** NPT acc. to ANSI B1.20.1

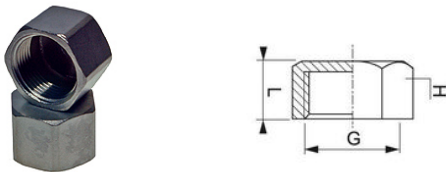

Size G	L in mm	H in mm	Weight in kg	Article no.
1/4"	12	17	0,010	GF04303001
3/8"	16	21	0,020	GF04303002
1/2"	18	24	0,025	GF04303003
3/4"	18	30	0,050	GF04303004
1"	22	38	0,075	GF04303005
1 1/4"	22	46	0,110	GF04303006
1 1/2"	26	55	0,220	GF04303007
2"	26	65	0,260	GF04303008
2 1/2"	29	84	0,520	GF04303009
3"	34	95	0,670	GF04303010
4"	40	124	1,270	GF04303011

**plug \***

**Name:** plug (6-kt.)  
**Typ:** GF04-3  
**Material:** Stainless steel 316L  
**Connection:** male thread  
**Thread:** NPT acc. to ANSI B1.20.1

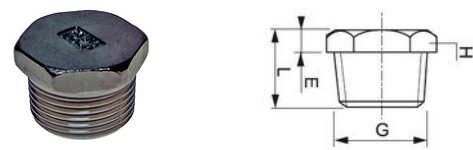

Size G	L in mm	E in mm	H in mm	Weight in kg	Article no.
1/8"	13	5	10	0,010	GF04301000
1/4"	16	5	14	0,015	GF04301001
3/8"	16	5	19	0,030	GF04301002
1/2"	21	7	23	0,055	GF04301003
3/4"	23	7	27	0,095	GF04301004
1"	25	7	36	0,165	GF04301005
1 1/4"	28	8	46	0,310	GF04301006
1 1/2"	32	10	50	0,440	GF04301007
2"	36	11	60	0,795	GF04301008
2 1/2"	37	12	78	1,340	GF04301009
3"	42	12	92	2,115	GF04301010

**socket \***

**Name:** socket  
**Typ:** GF04-3  
**Material:** Stainless steel 316L  
**Connection:** female thread  
**Thread:** NPT acc. to ANSI B1.20.1

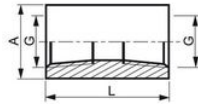

Size G	A in mm	L in mm	Weight in kg	Article no.
1/8"	14	25	0,016	GF04302000
1/4"	18	28	0,029	GF04302001
3/8"	22	32	0,037	GF04302002
1/2"	25	36	0,070	GF04302003
3/4"	32	42	0,100	GF04302004
1"	38	45	0,162	GF04302005
1 1/4"	50	55	0,239	GF04302006
1 1/2"	55	55	0,273	GF04302007
2"	65	60	0,444	GF04302008

**reducing socket \***

**Name:** reducing socket  
**Typ:** GF04-9  
**Material:** Stainless steel 316L  
**Connection:** female thread  
**Thread:** NPT acc. to ANSI B1.20.1

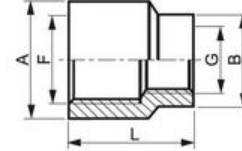

Size FxG	L in mm	A in mm	B in mm	Weight in kg	Article no.
1/4" x 1/8"	27	18	14	0,025	GF04900000
3/8" x 1/4"	30	22	17	0,045	GF04900002
1/2" x 1/4"	36	25	17	0,070	GF04900003
1/2" x 3/8"	36	25	21	0,070	GF04900004
3/4" x 3/8"	38	32	21	0,120	GF04900005
3/4" x 1/2"	38	32	27	0,110	GF04900006
1" x 1/2"	43	40	27	0,150	GF04900008
1" x 3/4"	43	40	33	0,150	GF04900009
2" x 1"	57	70	42	0,670	GF04900019
2" x 1 1/4"	57	70	55	0,650	GF04900020
2" x 1 1/2"	57	70	60	0,650	GF04900021

**reducing piece \***

**Name:** reducing piece  
**Typ:** GF04-6  
**Material:** Stainless steel 316L  
**Connection:** male x female thread  
**Thread:** NPT acc. to ANSI B1.20.1

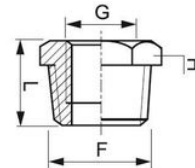

Size FxG	L in mm	H in mm	Weight in kg	Article no.
1/4" x 1/8"	13	14	0,010	GF04600000
3/8" x 1/8"	15	19	0,020	GF04600001
3/8" x 1/4"	15	19	0,020	GF04600002
1/2" x 1/8"	18	23	0,045	GF04600003
1/2" x 1/4"	18	23	0,035	GF04600004
1/2" x 3/8"	18	23	0,025	GF04600005
3/4" x 1/4"	22	27	0,070	GF04600006
3/4" x 3/8"	22	27	0,060	GF04600007
3/4" x 1/2"	22	27	0,040	GF04600008
1" x 1/4"	23	36	0,165	GF04600009.1
1" x 3/4"	23	36	0,075	GF04600011
1 1/4" x 3/4"	27	46	0,220	GF04600013
1 1/4" x 1"	27	46	0,135	GF04600014
1 1/2" x 3/4"	30	50	0,340	GF04600015
1 1/2" x 1"	30	50	0,265	GF04600016
1 1/2" x 1 1/4"	30	50	0,130	GF04600017
2" x 1 1/2"	34	60	0,350	GF04600020

**\* pressure recommendation for all threaded fittings TYPE GF04:**  
 Up to DN40: max. 64 bar (water with room temperature)  
 DN50 upwards: max. 40 bar (water with room temperature)

Image similar, subject change without notice.