

Compensator TYPE KP05

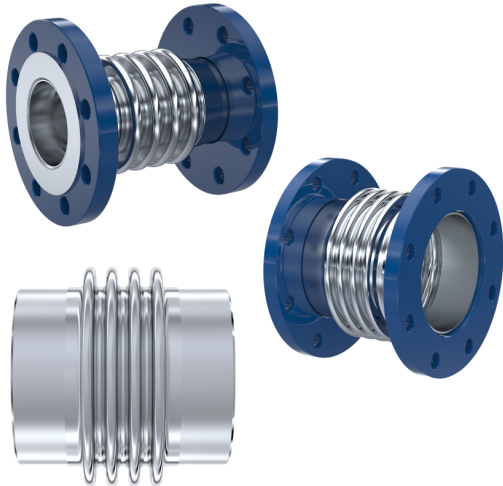

Description:

A compensator is always used when vibrations in a system have to be absorbed.

Product features:

- Recording of axial movements
- Vibration and noise damping connection of pipelines
- Compensation of assembly inaccuracy
- Reduction of forces and moments at connections
- Applicable in e.g. mechanical engineering, building services engineering, power engineering

Connection:
DN50 – DN300

Construction:
straight form

Pressure:
0 – 10 bar – depending on design

Temperature:
-10°C to +400°C – depending on design

Type:	Axial expansion joint with stainless steel bellows		
Flange material:	Carbon steel (235JR)		
Welding ends material:	Carbon steel (P235GH-TC1)		
Bellows material:	Stainless steel AISI 316T		
Cuff:	execution 00	Flared flange	-10°C up to +300°C
	execution 01	Fixed flange	-10°C up to +300°C
	execution 02	Welding end	-10°C up to +400°C
Pressure:	PN10		
Option (on request):	Other nominal sizes, pressure ratings and overall lengths, with special coating, galvanizing or hot-dip galvanizing Extension by guide or protection tube.		

Axial compensator with welding ends:

Axial expansion joint in compact design, consisting of multi-shaft and multi-layer metal bellows with weld ends (spigots) made of standardized pipes according to EN 10216/10217 ff or rolled from sheet metal according to EN 10028 ff.

Axial compensator with fixed flanges:

Axial expansion joint in compact design, consisting of multi-shaft and multi-layer metal bellows with standardized fixed flanges according to EN 1092-1 type 01.

Axial compensator with flared flanges:

Axial expansion joint in compact design, consisting of multi-shaft and multi-layer metal bellows with rotatable, standardized flared flanges according to EN 1092-1 type 02.

Dimensions:

Axial compensator with flared flanges:

Nominal diameter		Length	Bellow			Flange		
			Outer diameter	Waved length	Effective cross cut	Hole pattern acc. to EN1092	Flare diameter	Sheet thickness
DN		BL	Da	Lb	Ae	PN	d1	C1
mm	in	mm	mm	mm	cm ²			
50	2"	200	84	109	42,1	16	102	20
65	2 1/2"	200	105	104	65,5	16	122	20
80	3"	200	118	107	86	16	138	20
100	4"	200	141	122	126	16	158	22
125	5"	200	174	128	191	16	188	22
150	6"	200	207	120	273	16	212	24
200	8"	200	262	132	451	10	268	24
250	10"	200	322	63	689	10	320	26
300	12"	200	377	67	954	10	370	26

DN50 – DN80

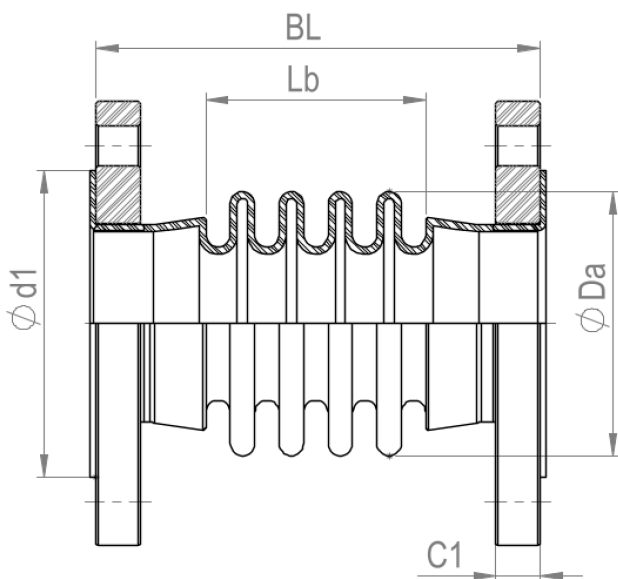

DN100 – DN300

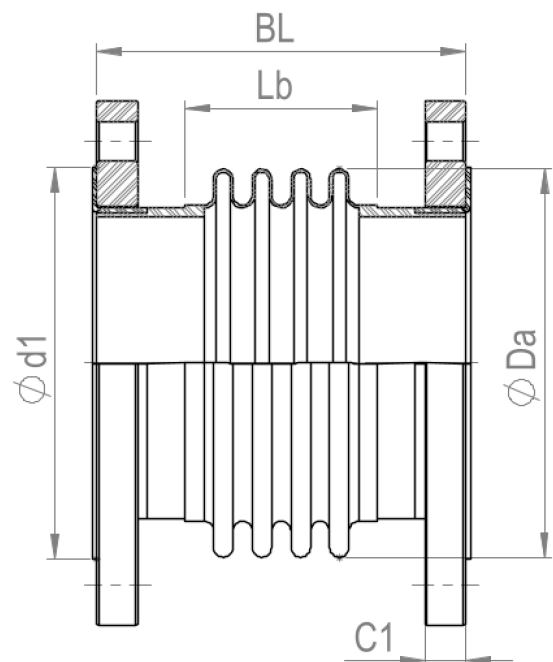

Axial compensator with fixed flanges:

Nominal diameter		Length	Bellow			Flange	
			Outer diameter	Waved length	Effective cross cut	Hole pattern acc. to EN1092	Sheet thickness
DN		BL	Da	Lb	Ae	PN	C1
mm	in	mm	mm	mm	cm ²	-	mm
50	2"	200	84	109	41,8	16	20
65	2 ½"	200	105	104	65,5	16	20
80	3"	200	118	107	85,5	16	20
100	4"	200	142	122	127	16	22
125	5"	200	170	128	184	16	22
150	6"	200	205	120	267	16	24
200	8"	200	262	132	445	10	24
250	10"	200	321	63	683	10	26
300	12"	200	377	67	948	10	26

DN50 – DN80

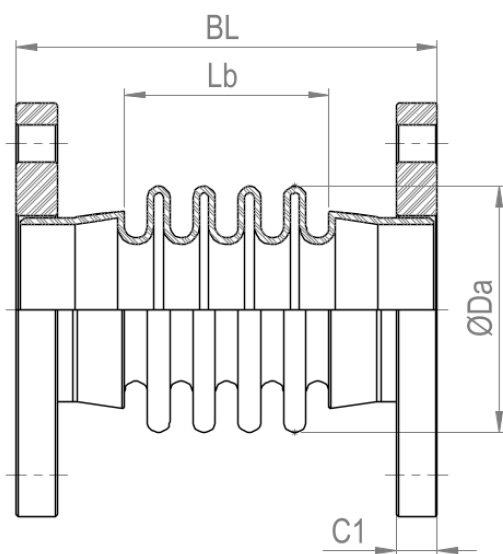

DN100 – DN300

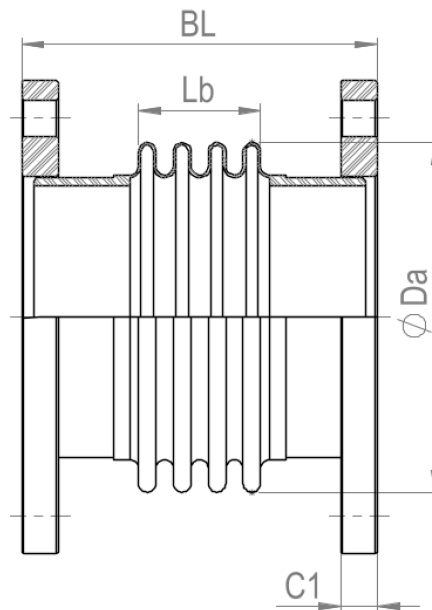

Axial compensator with welding ends:

Nominal size		Length	Welding end		Bellow		
			Outer diameter	Wall thickness	Outer diameter	Waved length	Effective cross cut
DN		BL	da	s	da	Lb	Ae
mm	in	mm	mm	mm	mm	mm	cm ²
50	2"	250	60,3	2,9	84	109	42,1
65	2 ½"	250	76,1	2,9	105	104	65,5
80	3"	250	88,9	3,2	118	107	86
100	4"	250	114,3	3,6	142	122	132
125	5"	250	139,7	4,0	174	128	197
150	6"	250	168,3	4,5	207	120	281
200	8"	250	219,1	6,3	265	132	466
250	10"	250	273	6,3	321	63	700
300	12"	250	323,9	7,1	373	67	962

DN50 – DN80

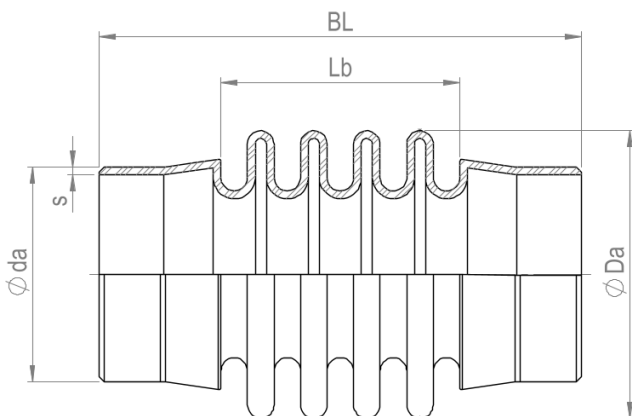

DN100 – DN300

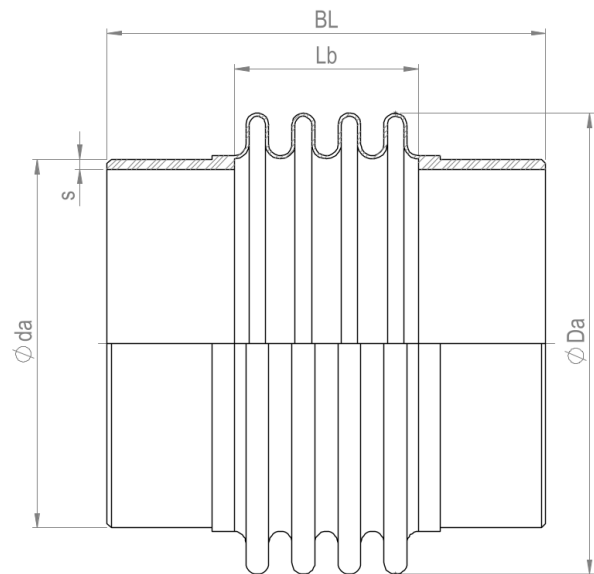

Axial rotation:

DN	50	65	80	100	125	150	200	250	300
KP05*	±17mm	±21mm	±17mm	±22mm	±30mm	±27mm	±30mm	±18mm	±12,5mm

* all types

Weight in kg:

DN	50	65	80	100	125	150	200	250	300
KP0500	6,4	7,8	8,8	11	13	17	22	28	34
KP0501	6,5	7,5	8,8	11	12	17	23	29	35
KP0502	0,7	1,3	1,4	1,7	2,4	3,3	6,2	8,2	11

Article number:

Type	Connection	Bellows	Size
KP05	00 – flared flange 01 – fixed flange 02 – welding end	00 – stainless steel	05 – DN25
			06 – DN32
			07 – DN40
			08 – DN50
			09 – DN65
			10 – DN80
			11 – DN100
			12 – DN125
			13 – DN150
			14 – DN200
			15 – DN250
			16 – DN300

Example Nr. KP05000010:

KP05 | 00 | 00 | 10

Compensator with flared flange and stainless steel bellows

Connection: flared flange DIN EN 1902-1 PN10

Bellows: stainless steel

Size: DN80

Illustration similar, subject to technical and dimensional changes.